

ACCESSORIES

EXTENSION

2600

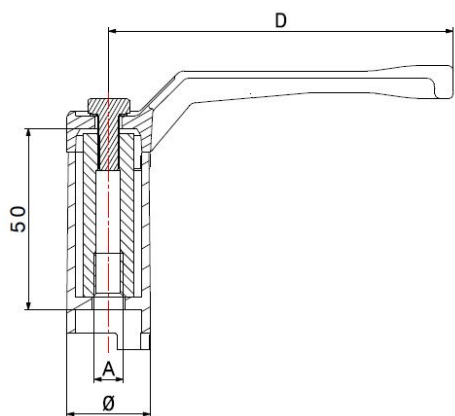
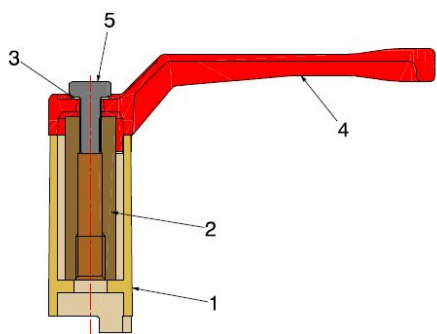

- Nickel-plated extension for water ball valve

COMPONENTS

POS.	PART NAME	N°	MATERIAL
1	Extension	1	CW617N UNI-EN 12165 nickel-plated
2	Screw stay	1	CW617N UNI-EN 12164
3	Washer	1	Galvanised iron
4	Lever	1	Lacquered aluminium
5	Screw	1	Galvanised iron

TO USE WITH: 26001133

7600	1/2" - 3/4"
7605	1/2" - 3/4"
7615	1/2" - 3/4"
7645	1/2" - 3/4"

TO USE WITH: 26001134

7951	1/2"
7956	15 - 22
7957	1/2"
7960	3/8" - 1/2" - 3/4"
7966	12 - 15 - 18 - 22

TO USE WITH: 26001135

7600	1" - 1.1/4"
7605	1" - 1.1/4"
7615	1" - 1.1/4"
7645	1" - 1.1/4"
7951	3/4" - 1"
7956	28
7957	3/4" - 1"
7960	1" - 1.1/4"
7966	28 - 35

TO USE WITH: 26001136

7600	1.1/2" - 2"
7605	1.1/2" - 2"
7615	1.1/2" - 2"
7645	1.1/2" - 2"
7951	1.1/4" - 1.1/2" - 2"
7957	1.1/4" - 1.1/2" - 2"
7960	1.1/2" - 2"

TO USE WITH: 26001137

7951	2.1/2" - 3" - 4"
------	------------------

DIMENSIONS

	Ø=23 A=4 M6 D=95	Ø=23 A=6 M8 D=95	Ø=30 A=6 M8 D=120	Ø=36 A=8 M12 D=150	Ø=50 A=14x16 M12 D=240
CODE	26001133	26001134	26001135	26001136	26001137