

HOMEGAS BONOMI

3 WAY HOMEGAS BUILT-IN BOX

7940

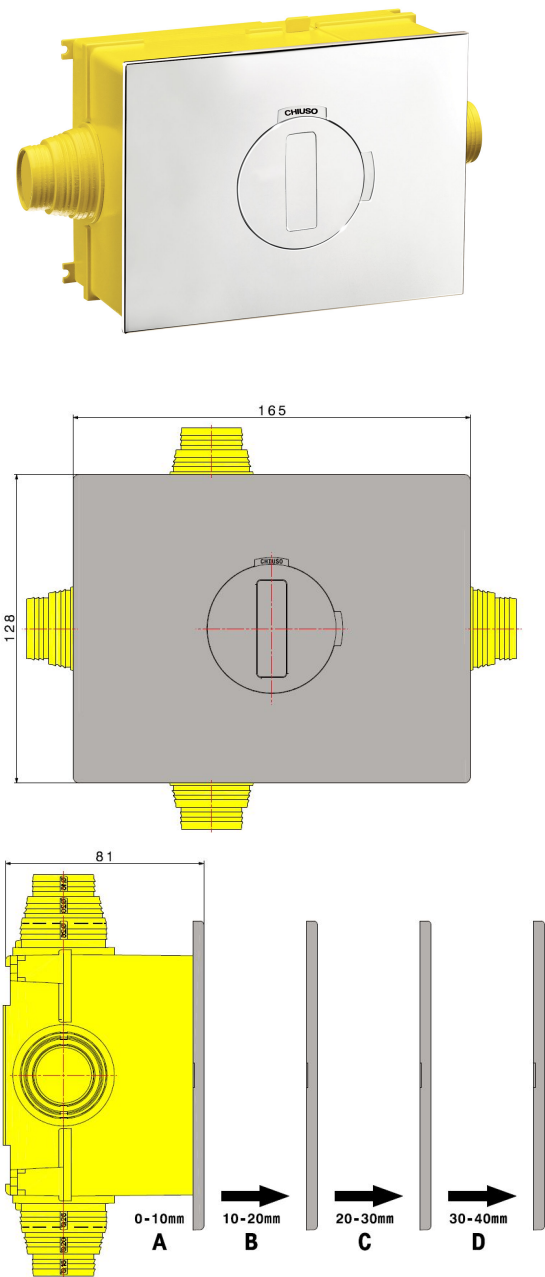

HOMEGAS Bonomi can be installed in appliances with a net heat input not exceeding 35KW and it features a DN20 full bore valve for a flow that meets the client needs. HOMEGAS Bonomi combines practicality, design and safety.

Features:

- User interface with an innovative design, open/closed status indicated, reduced protrusion from wall, corresponding to 5mm
- Chrome-plated finishing
- Open/closed concealed control with safety device (push and turn) to avoid inadvertent operations
- Equipped with sheath sleeves for ventilation, adjustable to the measures: 16mm, 20 mm, 26 mm
- Equipped with a set of 4 extensions for valve operation that allows an installation with an in-wall depth up to 40mm (from the tile surface)

Installation :

- Standard installation with expansion joints
- Possibility of installing and regulating the in-wall depth on drywalls thanks to its specific bracket, accessory code 79390000XA
- Calipers to identify the correct extension to use according to the in-wall depth
- Plastic protection of components during installation phases
- Possibility to connect the valve to the PEX-AL-PEX pipe through the specific fitting, code 4406
- Possibility to connect the valve to the copper pipe through the specific fitting, code 7949

Maintenance:

- Easy access for valve maintenance/substitution, with no need for masonry work

COMPONENTS

PART NAME	N°	MATERIAL
3/4" M/M valve with 3 ways	1	-
Knob	1	ABS chrome-plated
Extension	4	Plastic
Safety stop	1	Plastic
Frame	1	Plastic
Hose connection	4	Plastic
Box	1	Plastic
Chrome plate	1	ABS chrome-plated
Screw 3,5x32	4	Galvanised iron
Screw 3,5x50	8	Galvanised iron
Spring	2	AISI 302 stainless steel