

COMPRESSION FITTINGS FOR PEX-AL-PEX
PIPES

ANGLE BALL VALVE WITH
COMPRESSION END

8646

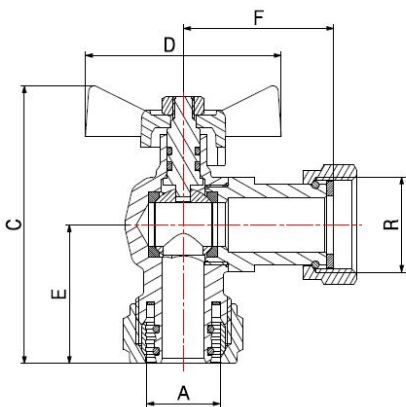
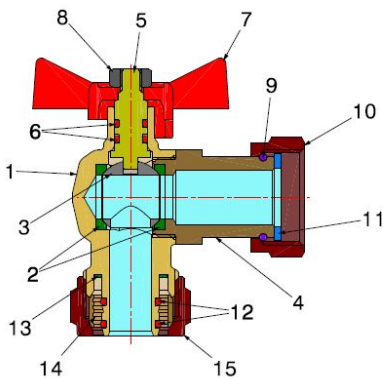

- Angle compression ball valve with swivel nut and T handle
- Maximum operating pressure of 10 bar
- Temperature range between min 0°C - max +95°C

Valve suitable for distributing and interrupting fluids that are generally non-corrosive, compatibly with the valve materials. Heating, plumbing and industrial systems are the ideal fields of application, such as high and low temperature heating systems, HVAC, air-conditioning and water distribution. The ball seal is guaranteed by two PTFE seats. The operating mechanism seal features two O-Rings with an internally installed stem and anti-ejection system.

It is advisable to carry out a complete maneuver cycle at least once every three months in order to prevent limescale deposits that could compromise the valve functioning.

COMPONENTS

POS.	PART NAME	N°	MATERIAL
1	Body	1	CW617N UNI-EN 12165 nickel-plated
2	Seal	2	PTFE
3	Ball	1	CW617N UNI-EN 12164 chrome-plated
4	End connection	1	CW617N UNI-EN 12164 nickel-plated
5	Stem	1	CW617N UNI-EN 12164
6	O-Ring	2	EPDM Perox
7	Handle	1	Lacquered aluminium
8	Nut	1	Galvanised iron
9	Elastic ring	1	Stainless steel
10	Nut	1	CW617N UNI-EN 12165 nickel-plated
11	Gasket	1	Fasit Omnia
12	O-Ring	2	EPDM Perox
13	Washer	1	PTFE
14	Ogive	1	CW617N UNI-EN 12164
15	Nut	1	CW617N UNI-EN 12165 nickel-plated

DIMENSIONS

A	R	C	D	E	F
20x2	3/4"	77	54	38,5	40
26x3	1"	82	54	43,5	42

PACKAGING

	20 - 3/4"	26 - 1"
CODE	86462006R	86462608R
PCS BOX	10	8
PCS CARTON	100	80