

### WATER BALL VALVES

**TAMIGI**

**760200**

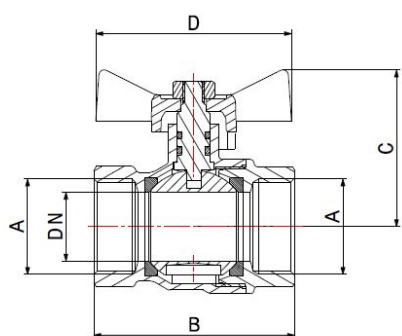
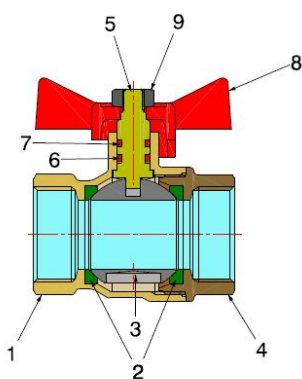

- F/F water ball valve with T handle
- Thread ISO 228
- Temperature range min -10°C - max +120°C

Valve suitable for distributing and interrupting liquids that are generally non-corrosive, compatibly with the valve materials. Plumbing, heating, industrial and agricultural sectors are the ideal fields of application. It's a full bore valve and the ball seal is guaranteed by two PTFE seats.

The operating mechanism seal features two O-Rings with an internally installed stem and anti-ejection system.

It is advisable to carry out a complete maneuver cycle at least once every three months in order to prevent limescale deposits that could compromise the valve functioning.

### COMPONENTS

POS.	PART NAME	N°	MATERIAL
1	Body	1	CW617N UNI-EN 12165 nickel-plated
2	Seal	2	PTFE
3	Ball	1	CW617N UNI-EN 12165 chrome-plated
4	End connection	1	CW617N UNI-EN 12165 nickel-plated
5	Stem	1	CW617N UNI-EN 12164
6	O-Ring	1	EPDM Perox
7	O-Ring	1	FKM
8	"T" handle	1	Lacquered aluminuim
9	Nut	1	Galvanised iron

### DIMENSIONS

DN	A	B	C	D	PN	KV*
8	1/4"	39	34	50	40	–
10	3/8"	39	34	50	40	–
15	1/2"	49	38	50	40	10,05
20	3/4"	55	42	50	40	24,56
25	1"	65	52	67	40	51,21

PRESSURE DROP see chart at the end of catalogue

### PACKAGING

	1/4"	3/8"	1/2"	3/4"	1"
CODE	76020002R	76020003R	76020004R	76020006R	76020008R
PCS BOX	25	25	20	15	8
PCS CARTON	300	300	240	150	80