

PRESS FITTINGS FOR PEX-AL-PEX PIPES

## STRAIGHT FITTING WITH SWIVEL NUT

4006

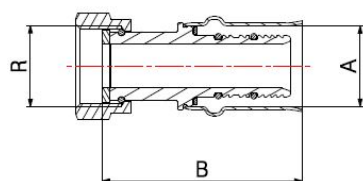
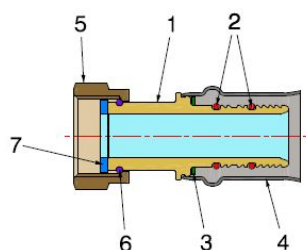

- Straight press fitting with swivel nut
- Maximum operating pressure 10 bar
- Thread ISO 228
- Temperature range min 0°C - max +95°C
- The jaws for the fittings pressing have to be **TH** profile.

Fitting suitable for distributing fluids that are generally non-corrosive, compatibly with the fitting materials. Heating, plumbing and industrial systems are the ideal fields of application, such as high and low temperature heating systems, air-conditioning and distribution of drinking water. The tightness is guaranteed by two EPDM PEROX O-Rings, particularly recommended with water-glycol solutions, with a maximum glycol presence of 50%. The steel sleeve pressing, carried out with electromechanical tools, ensures a perfect and indivisible crimping to the pipe as well as an excellent resistance to external stress.

## ACS

### COMPONENTS

POS.	PART NAME	N°	MATERIAL
1	Fitting	1	CW617N UNI-EN 12164
2	O-Ring	2	EPDM Perox
3	Washer	1	PTFE
4	Bushing	1	AISI 304 stainless steel
5	Nut	1	CW617N UNI-EN 12165 (hot pressed) - CW617N UNI-EN 12164 (from bar)
6	Snap ring	1	Stainless steel
7	Gasket	1	Fasit Omnia

\* Measurements without snap ring component

### DIMENSIONS

A	R	B
16	3/8"	54
16*	1/2"	56
16*	3/4"	56
20	1/2"	57
20*	3/4"	56
26	3/4"	60
26*	1"	58
32	1"	63
32*	1.1/4"	57

FOLLOWING THE DIMENSIONS FROM 40 TO 75

### PACKAGING

	16 - 3/8"	16 - 1/2"	16 - 3/4"	20 - 1/2"	20 - 3/4"	26 - 3/4"	26 - 1"	32 - 1"	32 - 1.1/4"
CODE	40061603	40061604	40061606	40062004	40062006	40062606	40062608	40063208	40063210
PCS BAG	10	10	10	10	10	5	5	5	5
PCS CARTON	250	200	150	150	150	100	100	60	50