

PRESS FITTINGS FOR PEX-AL-PEX PIPES

FEMALE TEE FITTING

4032

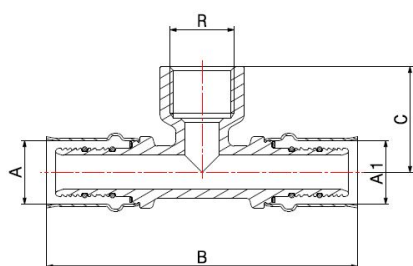
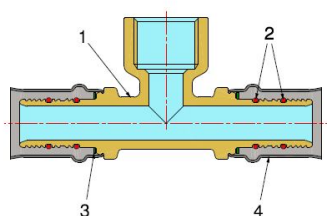

- Female tee press fitting
- Maximum operating pressure 10 bar
- Thread EN 10226-1
- Temperature range min 0°C – max +95°C
- The jaws for the fittings pressing have to be **TH** profile.

Fitting suitable for distributing fluids that are generally non-corrosive, compatibly with the fitting materials.

Heating, plumbing and industrial systems are the ideal fields of application, such as high and low temperature heating systems, air-conditioning and distribution of drinking water.

The tightness is guaranteed by two EPDM PEROX O-Rings, particularly recommended with water-glycol solutions, with a maximum glycol presence of 50%.

The steel sleeve pressing, carried out with electromechanical tools, ensures a perfect and indivisible crimping to the pipe as well as an excellent resistance to external stress.

ACS**COMPONENTS**

POS.	PART NAME	N°	MATERIAL
1	Fitting	1	CW617N UNI-EN 12165
2	O-Ring	4	EPDM Perox
3	Washer	2	PTFE
4	Bushing	2	AISI 304 stainless steel

DIMENSIONS

A	R	A1	C	C
16	1/2"	16	97	34
18	1/2"	18	100	34
18	3/4"	18	100	35
20	1/2"	20	100	34
20	3/4"	20	100	35
26	1/2"	26	104	40
26	3/4"	26	104	40
32	1/2"	32	110	45
32	3/4"	32	110	46
32	1"	32	110	46

FOLLOWING THE DIMENSIONS FROM 40 TO 75

PACKAGING

	16 - 1/2" - 16	18 - 1/2" - 18	18 - 3/4" - 18	20 - 1/2" - 20	20 - 3/4" - 20	26 - 1/2" - 26	26 - 3/4" - 26	32 - 1/2" - 32	32 - 3/4" - 32	32 - 1" - 32
CODE	4032160416	4032180418	4032180618	4032200420	4032200620	4032260426	4032260626	4032320432	4032320632	4032320832
PCS BAG	5	5	5	5	5	5	5	2	2	2
PCS CARTON	100	80	50	80	50	60	50	30	30	30