

WATER BALL VALVES

MISSOURI

796601



- DZR water ball valve with compression ends
- Temperature range min -10°C - max +120°C

Valve suitable for distributing and interrupting liquids that could cause dezincification problems. Plumbing and heating systems and industrial sector are the ideal fields of application. It's a full bore valve and the ball seal is guaranteed by two PTFE seats. The operating mechanism seal features an adjustable gland with a PTFE ring and a EPDM PEROX O-Ring. The stem is internally installed with an anti-ejection system. It is advisable to carry out a complete maneuver cycle at least once every three months in order to prevent limescale deposits that could compromise the valve functioning.

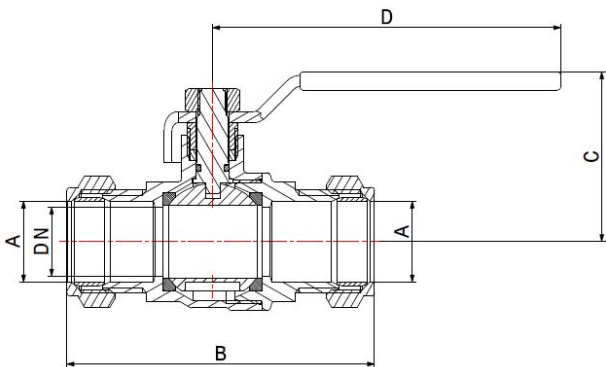
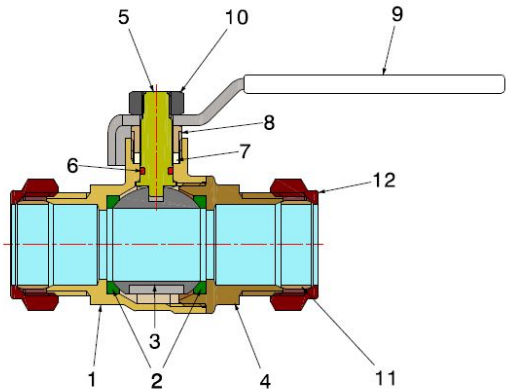

COMPONENTS

POS.	PART NAME	N°	MATERIAL
1	Body	1	CW602N UNI-EN 12165
2	Seal	2	PTFE
3	Ball	1	CW602N UNI-EN 12165 chrome-plated
4	End connection	1	CW602N UNI-EN 12165
5	Stem	1	CW602N UNI-EN 12165
6	O-Ring	1	EPDM Perox
7	Gland packing	1	PTFE
8	Gland	1	CW617N UNI-EN 12164
9	Lever	1	Galvanised iron and PVC coated
10	Nut	1	Galvanised iron
11	Ogive	2	CW617N UNI-EN 12164
12	Nut	2	CW617N UNI-EN 12165

DIMENSIONS

DN	A	B	C	D	PN
10	12	78	40	95	40
15	15	79	42	95	40
15	18	80	42	95	40
20	22	85	47	95	40
25	28	100	58	120	40
32	35	115	66	120	30

PACKAGING

	12	15	18	22	28	35
CODE	79660112W	79660115W	79660118W	79660122W	79660128W	79660135W
PCS BOX	12	12	12	10	8	-
PCS CARTON	120	120	120	100	40	20