

COMPRESSION FITTINGS FOR PEX-AL-PEX  
PIPES

ELBOW COMPRESSION  
FITTING WITH SWIVEL NUT

3956

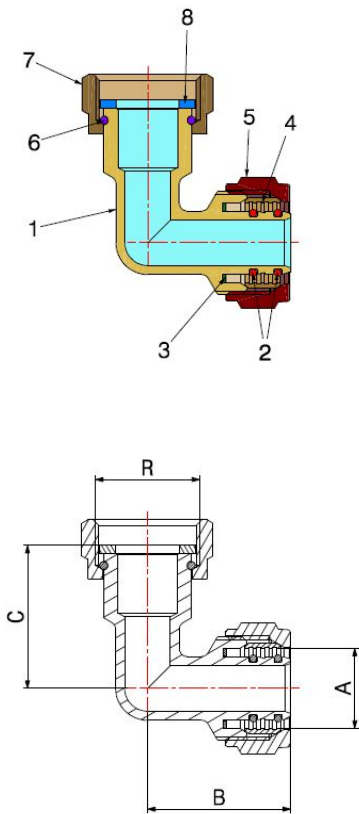

- Elbow compression fitting with swivel nut
- Thread ISO 228
- Maximum operating pressure 10 bar
- Temperature range min 0°C - max +95°C

Fitting suitable for distributing fluids that are generally non-corrosive, compatibly with the fitting materials. Heating, plumbing and industrial systems are the ideal fields of application, such as high and low temperature heating systems, HVAC, air-conditioning and distribution of drinking water. The fitting features an external clamping nut to ensure a perfect crimping to the pipe and an excellent resistance to external stress.

COMPONENTS

POS.	DESCRIZIONE	N°	MATERIALE
1	Fitting	1	CW617N UNI-EN 12164 nickel-plated
2	O-Ring	2	EPDM Perox
3	Washer	1	PTFE
4	Ogive	1	CW617N UNI-EN 12164
5	Nut	1	CW617N UNI-EN 12165 nickel-plated
6	Elastic ring	1	Stainless steel
7	Nut	1	CW617N UNI-EN 12164 nickel-plated
8	Gasket	1	Fasit Omnia

DIMENSIONS

A	R	B	C
16x2	1/2"	31	32
20x2	3/4"	36	36
26x3	1"	41	42

PACKAGING

	16 - 1/2"	20 - 3/4"	26 - 1"
CODE	39561604	39562006	39562608
PCS BAG	10	10	5
PCS CARTON	150	100	50