

WATER BALL VALVES

MISSOURI

795601



- Water ball valve with compression ends
- Temperature range min -10°C - max +95°C

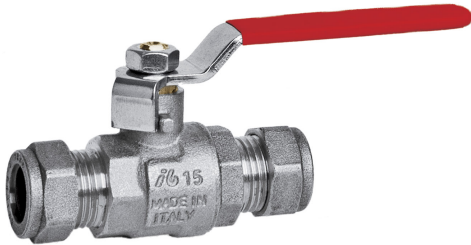

Valve suitable for distributing and interrupting liquids that are generally non-corrosive, compatibly with the valve materials. Plumbing, heating, industrial and agricultural sectors are the ideal fields of application. It's a full bore valve and the ball seal is guaranteed by two PTFE seats.

The operating mechanism seal features two O-Rings with an internally installed stem and anti-ejection system.

It is advisable to carry out a complete maneuver cycle at least once every three months in order to prevent limescale deposits that could compromise the valve functioning.

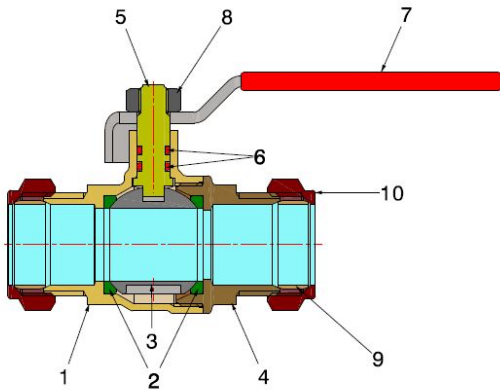

COMPONENTS

POS.	PART NAME	N°	MATERIAL
1	Body	1	CW617N UNI-EN 12165 nickel-plated
2	Seal	2	PTFE
3	Ball	1	CW617N UNI-EN 12165 chrome-plated
4	End connection	1	CW617N UNI-EN 12165 nickel-plated
5	Stem	1	CW617N UNI-EN 1214
6	O-Ring	2	NBR
7	Lever	1	Galvanised iron and PVC coated
8	Nut	1	Galvanised iron
9	Ogive	2	CW617N UNI-EN 12164
10	Nut	2	CW617N UNI-EN 12165 nickel-plated

DIMENSIONS

DN	A	B	C	D	PN
15	15	79	42	95	40
20	22	85	46	95	40
25	28	102	58	120	40

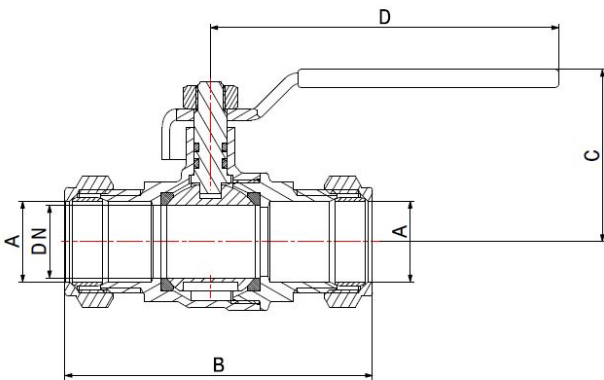

PACKAGING

	15	22	28
CODE	79560115R	79560122R	79560128R
PCS BOX	12	10	8
PCS CARTON	120	100	40