

COMPRESSION FITTINGS FOR PEX-AL-PEX
PIPES

TOILET TANK VALVE

7668



- 3/8" Tank tap with PEX-AL-PEX 16 connection
- ISO 228 thread
- Maximum operating pressure 10 bar
- Temperature range min 0°C - max +95°C

Tap suitable for distributing, regulating and interrupting fluids that are generally non-corrosive, compatibly with the valve materials. Plumbing and heating systems are the ideal field of application, where it is used as shut-off tap before other appliances such as taps, mixers or toilet tanks.

The seat tightness is guaranteed by a NBR seal.

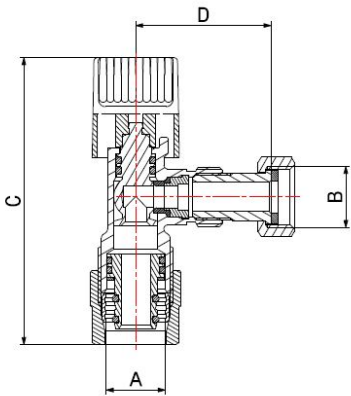
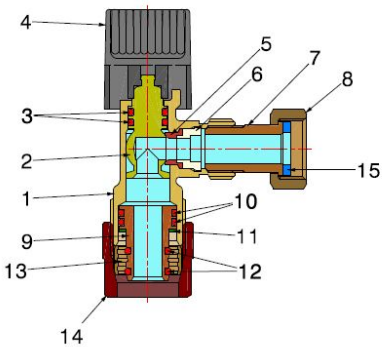

COMPONENTS

POS.	PART NAME	N°	MATERIAL
1	Body	1	CW617N UNI-EN 12165 chrome-plated
2	Stem with ball	1	CW617N UNI-EN 12164
3	O-Ring	2	EPDM Perox
4	Handle	1	ABS chrome-plated
5	Shaped gasket	1	NBR
6	Snap seal	1	Nylon
7	Pipe	1	CW617N UNI-EN 12164 chrome-plated
8	Nut	1	CW617N UNI-EN 12164 chrome-plated
9	Hose-end	1	CW617N UNI-EN 12164
10	O-Ring	2	EPDM Perox
11	Washer	1	PTFE
12	O-Ring	2	EPDM Perox
13	Ogive	1	CW617N UNI-EN 12164
14	Nut	1	CW617N UNI-EN 12164 chrome-plated
15	Gasket	1	Fasit Omnia

DIMENSIONS

A	B	C	D	PN
16x2	3/8"	79	38	10

PACKAGING

	16 - 3/8"
CODE	76681603
PCS BOX	10
PCS CARTON	100