

CHECK VALVES

HORIZONTAL VALVE  
METAL SEAT

3000

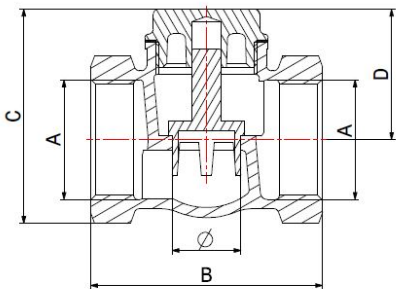
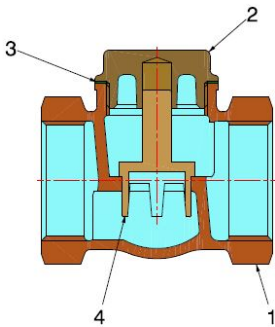

- Horizontal valve metal seat
- Thread ISO 228 - on request NPT
- Temperature range min -10°C - max +100°C / min +14°F - max +212°F

Valve suitable for distributing, regulating and interrupting liquids that could cause dezincification problems. It is especially recommended in harsh environments, such as marine ones, as long as the liquid is not salt water or with impurities that could damage the sealing. Shipbuilding, plumbing, heating and industrial sectors are the ideal fields of application. The flow direction is indicated by an arrow on the valve body, while the installation can only be in horizontal position.

The seat tightness is guaranteed by a metal-to-metal seal.

COMPONENTS

POS.	PART NAME	N°	MATERIAL
1	Body	1	Bronze CC491K UNI-EN 1982:2000
2	Cap	1	CW617N UNI-EN 12164 ( 3/8" to 3/4" ) - CW617N UNI-EN 12165 ( 1" to 3" )
3	Cap gasket	1	PTFE
4	Valve seal	1	CW617N UNI-EN 12164 ( 1/2" to 1.1/2" ) - CW617N UNI-EN 12165 ( 2" to 3" )

DIMENSIONS MM

DN	A	B	C	D	Ø	PN
15	1/2"	50	45	30	11	16
20	3/4"	55	52	33	13	16
25	1"	64	59	36	19	16
32	1.1/4"	73	71	42	23	16
40	1.1/2"	83	80	48,5	29	16
50	2"	88	95	56,5	36	16
65	2.1/2"	150	128	80,5	62	16

PACKAGING

	1/2"	3/4"	1"	1.1/4"	1.1/2"	2"	2.1/2"
CODE	3000010D00	3000010E00	3000010F00	3000010G00	3000010H00	3000010I00	3000010J00
PCS BOX	20	15	10	-	-	-	-
PCS CARTON	160	120	80	50	40	30	8