

SAFETY VALVES

SAFETY VALVE

3635

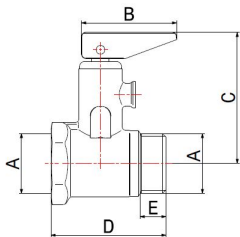

- Water heater safety valve with lever

Valve suitable to control the maximum internal pressure of water heaters.

When the set pressure is reached, the valve discharges the exceeding pressure into the atmosphere, avoiding dangerous pressure values.

The lever allows to check, ideally once a month, the valve proper functioning and, if necessary, to empty the heater.

The valve is pre-calibrated in our factory with a standard opening pressure of 8,5 bar.

DIMENSIONS			
A	B	C	D
1/2"	33	65	46
3/4"	33	75	57

PACKAGING		
	1/2"	3/4"
CODE	36350004	36350006
PCS BOX	20	10
PCS CARTON	180	90