

WATER BALL VALVES

DANUBIO

774801



- M/M water ball valve with iron lever
- Thread ISO 228
- Temperature range min -10°C - max +95°C

Valve suitable for distributing and interrupting liquids that are generally non-corrosive, compatibly with the valve materials. Plumbing, heating, industrial and agricultural sectors are the ideal fields of application. It's a standard bore valve and the ball seal is guaranteed by two PTFE seats.

The operating mechanism seal features two O-Rings with an internally installed stem and anti-ejection system.

It is advisable to carry out a complete maneuver cycle at least once every three months in order to prevent limescale deposits that could compromise the valve functioning.

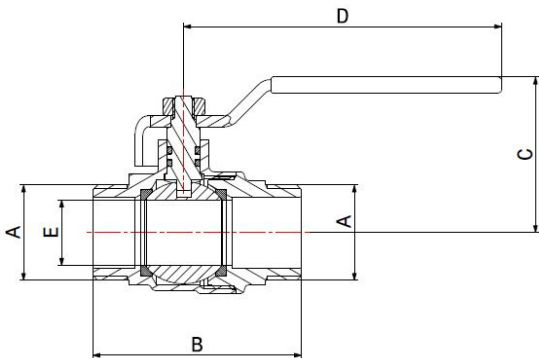
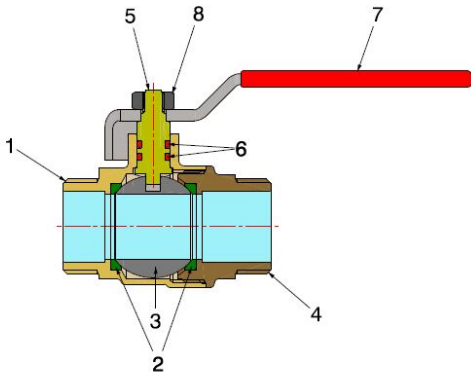

COMPONENTS

| POS. | PART NAME      | N° | MATERIAL                          |
|------|----------------|----|-----------------------------------|
| 1    | Body           | 1  | CW617N UNI-EN 12165 nickel-plated |
| 2    | Seal           | 2  | PTFE                              |
| 3    | Ball           | 1  | CW617N UNI-EN 12165 chrome-plated |
| 4    | End connection | 1  | CW617N UNI-EN 12165 nickel-plated |
| 5    | Stem           | 1  | CW617N UNI-EN 12164               |
| 6    | O-Ring         | 2  | NBR                               |
| 7    | Lever          | 1  | Galvanised iron and PVC coated    |
| 8    | Nut            | 1  | Galvanised iron                   |

DIMENSIONS

| DN | A    | B  | C  | D  | E    | PN |
|----|------|----|----|----|------|----|
| 15 | 1/2" | 52 | 40 | 87 | 14   | 40 |
| 20 | 3/4" | 58 | 43 | 87 | 18   | 40 |
| 25 | 1"   | 69 | 48 | 95 | 22,5 | 40 |

PACKAGING

|            |           |           |           |
|------------|-----------|-----------|-----------|
|            | 1/2"      | 3/4"      | 1"        |
| CODE       | 77480104R | 77480106R | 77480108R |
| PCS BOX    | 25        | 15        | 10        |
| PCS CARTON | 250       | 150       | 100       |